

COSMOFIN

Waterproofing Systems

WATERPROOFING FOR

- * **Roofs**
- * **Balconies**
- * **Basements**

The Cosmofin range of membranes consist of extruded, high polymer, soft PVC sheet membranes together with a galvanised steel system of profiles.

Cosmofin membranes are designed for permanent exposure in Australian conditions.

Cosmofin - from the makers of Wolfin

The Cosmofin System Consists of:

- Cosmofin membrane: A high polymer, soft PVC sheet membrane.
- Cosmofin bonded profiles: Galvanised steel to which the membrane has been bonded.
- THF: Cold welding solvent

Tools Required:

- Leister hot-air gun with 20mm nozzle
- 40mm silicone roller
- 80mm silicone roller
- Cosmofin welding bottle & brush-head
- Scissors
- Impact drill

Cosmofin Laps and Joints:

Cosmofin laps and joints are welded. Welding can be by hot air or by cold solvent. weld strength is excellent. The membrane can be welded direct to PVC pipes.

Installation Instructions:

Installation instructions for the Cosmofin System are available from Projex Group.

The Cosmofin Product Range:

- **1.5mm Cosmofin FG:** High-polymer, Soft PVC membrane, available in light grey. It is reinforced internally with polyester.
- **1.5mm Cosmofin F:** High-polymer, Soft PVC membrane, available in light grey. This is unreinforced allowing greater structural movement.
- **1.5mm Cosmofin GGV:** High-polymer, Soft PVC membrane, available in light grey. It is reinforced internally with polyester and backed with fleece. Can be laid over bitumen
- **Terostat Fixband:** 120mm wide self-adhesive tape used to seal Cosmofin to wall where render to be applied over.
- **Terokal Alufixband:** 120mm wide self-adhesive tape used to seal Cosmofin to the wall. Should only used in balcony or garden bed or small terrace situations. To be used in conjunction with **Terokal 914** adhesive.
- **Terokal 325:** The adhesive to bond Cosmofin GGV to almost any substrate.

Cosmofin Steel Profiles (Edge fixing system)

These are specially cut and bent from Cosmofin-steel to be used to terminate the membrane system and to hold down the membrane where design dictates. The membrane is welded direct to the profiles encapsulating any fixings. The profiles can be secured to concrete, bricks, timber, steel and all solid surfaces.

Where Cosmofin can be used:

- Roof waterproofing
- Balcony waterproofing
- Retaining walls
- Cosmofin can be bonded or loose laid
- Cosmofin can be laid exposed
- Cosmofin can be laid under tiles, topping, ballast etc
- Cosmofin can be loose laid on damp substrates
- Only Cosmofin GGV is bitumen compatible

COSMOFIN®

The reinforced PVC membrane system manufactured in accordance with DIN 16734.
The system is completely homogeneous – all laps are welded – all accessories encapsulated.
The membrane is manufactured by extrusion – not calandared – eliminating built-in calandar shrinkage.

COSMOFIN® QUALITIES

- COSMOFIN® * UV STABLE. Safe to leave exposed in Australian conditions.
- COSMOFIN® * FULLY WELDED. All laps and connections are homogeneously welded.
- COSMOFIN® * EXTRUDED – LOW SHRINKAGE. No built in calandar tension.
- COSMOFIN® * REINFORCED. Strong but elastic reinforcement, with all lap edges presealed.
- COSMOFIN® * FLEXIBLE. Elastic up to 19%.
- COSMOFIN® * HOMOGENEOUS. When laid correctly, no reinforcement is exposed.
- COSMOFIN® * ROOT RESISTANT. Proven, guaranteed safety against plant roots.
- COSMOFIN® * MICRO-ORGANISM RESISTANT. Both sides of the membrane are safe.
- COSMOFIN® * ACID / ALKALI RESISTANT. Resists a wide variety of chemicals.

COSMOFIN® COMPONENTS

- COSMOFIN® FG** The standard reinforced membrane, 1.5 mm thick, light grey, with the side edges sealed beyond the reinforcement. Roll size: 1.1 metres x 20 metres long.
- COSMOFIN® F** Unreinforced detailing/closer strip membrane, 1.5 mm thick. Roll size: 550 mm x 20 metres long.
- COSMOFIN® THF** Tetrahydrofuran cold welding solvent. Package size: 5 litre tins.
- COSMOFIN® LIQUID** Used to seal cut laps to close reinforcement ends. Package size: 1 litre tins.
- COSMOFIN® STEEL** 24 gge galvanised steel with membrane factory bonded to one side. Four standard profile shapes are available and specials can be ordered if needed.

COSMOFIN® FG TECHNICAL DATA

PROPERTY	TEST (DIN 16734)	RESULT
UV STABILITY	Weathering 6000 MJ/m2	yes
PLANT ROOT RESISTANCE	FLL Laboratories (4 years)	yes
EXTERNAL QUALITY CONTROL	SKZ Wurtzburg – ISO 9001	yes
TENSILE STRENGTH	Pt. 5.6 Table 1	Long: 1417 N Trans: 1341 N
ELONGATION AT BREAK	Pt. 5.6 Table 1	Long: 15.8% Trans: 19.0%
SHEAR STRENGTH AT WELD	Pt. 5.7 Table 1	Break is outside weld
DELAMINATION FORCE	Pt. 5.9	190 N/5cm
COLD RESILIENCE	Pt. 5.14	No cracks
THERMAL EXPANSION	Pt. 5.6 Table 1	Long: 0.14% Trans: 0.06%
WATER PRESSURE	2 bar @ 24 hrs	Tight
PERFORATION TEST	Pt. 5.12	Tight
VAPOUR DIFFUSION	DIN 53122	27,000

COSMOFIN

Installation Recommendations

SUBSTRATE PREPARATION

All substrates to which the COSMOFIN membrane is to be applied must be sound, smooth, clean, dry and free from the residues of any foreign material.

Oil or bitumen residues must be removed.

Check the existing bond and/or compatibility before deciding to leave existing membranes in position.

While laying the membrane, keep the substrate swept clean and prevent stones or debris from lodging under the membrane.

MEMBRANE LAYING AND LAP WELDING

Layout: Setout the rolls so that they are used most economically, and the welds are minimised.

Side laps: Overlap each roll a minimum of 50 mm and weld the full width.

End laps: All as side laps.

Multi lap junctions (capillaries): Where these occur they are to be welded tight. Sealants should not be used.

Cut edges: All sheet or patch edges where the selvage is cut away, should be dressed with COSMOFIN Liquid so that they are "closed" against ponding water.

UPSTAND TERMINATIONS

Set the upstands to correct pond heights.

Two recommended COSMOFINSTEEL termination profiles are shown.

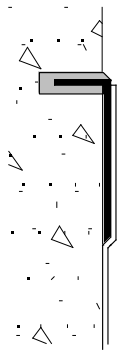

TYPE C 5 - SAWCUT

Where type C 5 is used, first sawcut a chase 6 wide x 20 deep, prime and prefill with sealant. Fit the profile while the sealant is wet.

TYPE C 5

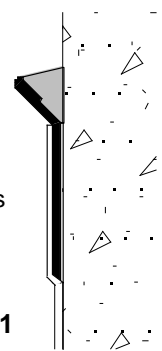

TYPE C 1 - SURFACE MOUNTED

Where type C 1 is used, apply a suitable sealant, properly primed, and ensure that all paint and contaminants are cleaned off the substrate.

TYPE C 1

PERIMETER TERMINATIONS

Two recommended COSMOFINSTEEL terminations are shown.

TYPE C 6 FREE EDGE TERMINATION

The COSMOFINSTEEL type C 6 profile is recommended at all free edges, gutter overlaps and the like.

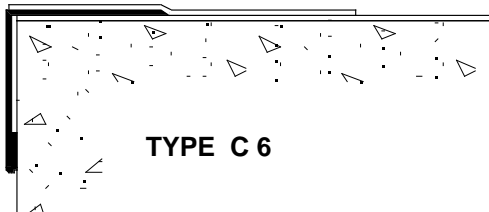

TYPE C 6

TYPE C 2 - BASE ANGLE FIXING

The COSMOFINSTEEL base angle profile is recommended at all horizontal / vertical junctions where structural or thermal movement may induce "coving" at upstands.

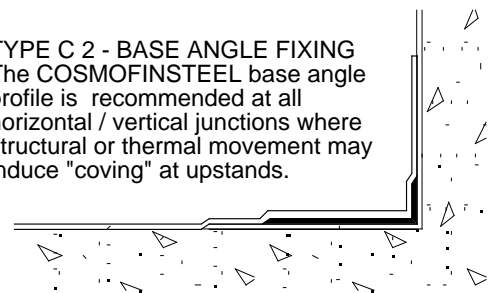

TYPE C 2

PROFILE FIXING

COSMOFINSTEEL profiles are supplied in 2 metre lengths. Space them 2 mm apart and join with 50 wide welded patches for the full girth of the profile. This jointing process is not required for Type C 2. Fix all profiles at 200 mm centres.

TECHNICAL ASSISTANCE

Projex staff are available on request to provide any assistance required.

PROJEX GROUP Pty Ltd

ACN 003 859 916

PO Box 98 Matraville NSW 2036

website: www.projex.com.au

tel: (02) 8336 1666

fax: (02) 8336 1670

email: mail@projex.com.au

COSMOFIN

Cosmofin...from the makers of Wolfin

Physical properties:

- UV Stability
- High tensile strength
- Easily repaired
(in the event of accidental damage)
- Vapour permeable

Quality assured:

Cosmofin is manufactured by Henkel GmbH under the terms of ISO 9001 standards

Applicators:

Cosmofin is sold only to experienced waterproofing contractors

Warranty:

Cosmofin materials are warranted to be suited for waterproofing throughout the world, including Australia and New Zealand



PROJEX GROUP PTY LTD
PO BOX 98
Matraville NSW 2036
PH: 61 2 8336 1666
FX: 61 2 8336 1670

E-mail: mail@projex.com.au ... Website: <http://www.projex.com.au>