

Where walls are shielded or well coated, the P1 detail can be used.

Carefully remove two or three courses in 1 metre drives or propped - all in accordance with sound underpinning principles. On completion replace with stiff high early strength mortar. Do not remove the adjacent drive less than three days after replacing the previous drive.

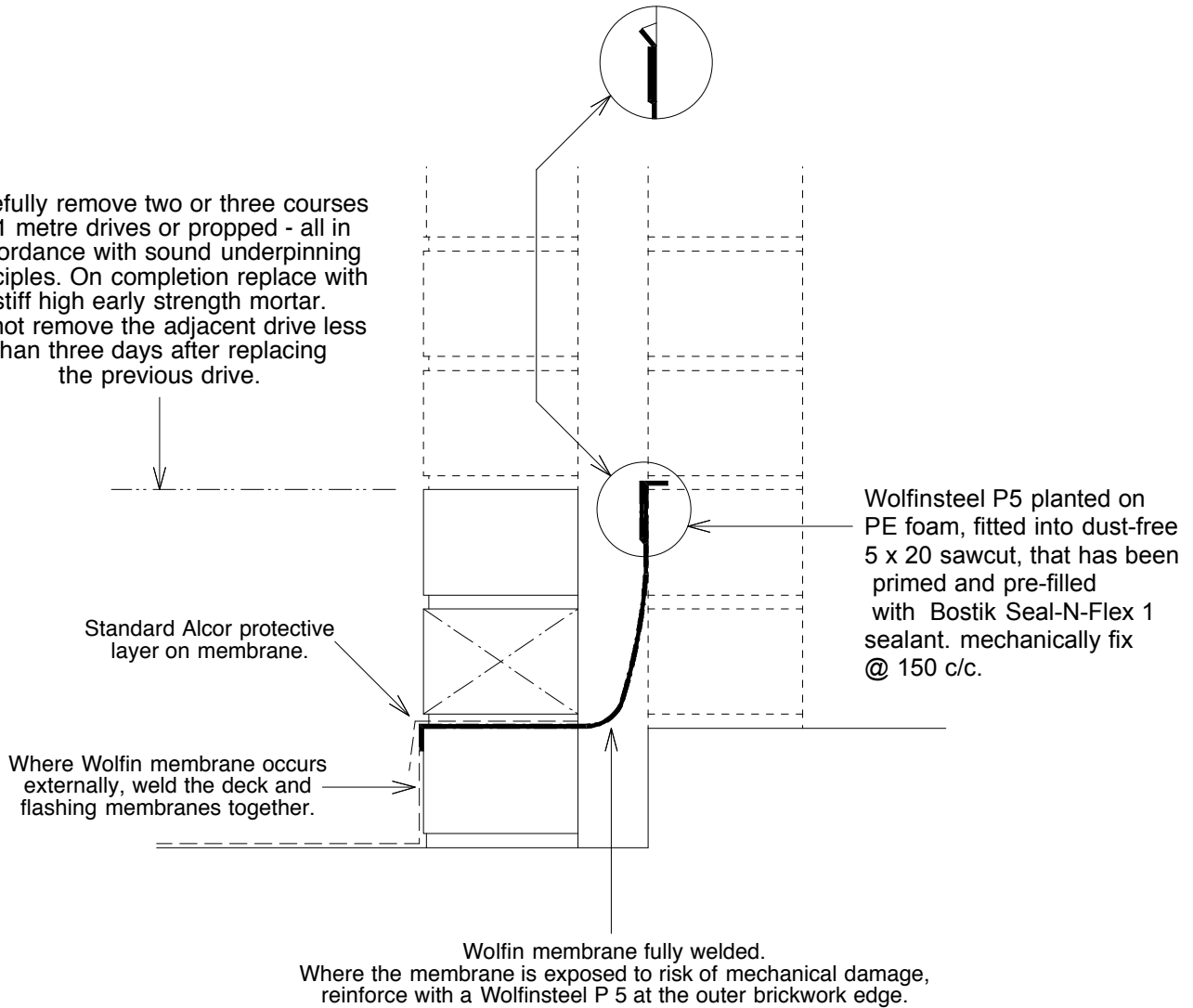

#### NOTES

All removal and replacement of brickwork is to be done carefully, to ensure no destabilisation of the walls.

Grind off any "sharps" from the outer edge of the lower bricks, so that the membrane is not at risk of puncture from beneath.

Ensure that the lower course of brickwork gives smooth full support to the membrane when the wall loads are reapplied. If necessary, mortar the top surface of the bricks smooth. This especially applies to extruded bricks.

© WOLFEN MEMBRANES AUSTRALIA PTY LTD

REV: JUNE 2013

### TYPICAL RETROFIT FLASHING

Scale: 1: 5

Date: May 2011

Dwg No: SD - 11